

STAFFORD COUNTY
RAPPAHANNOCK RIVER

PROPERTY LINE IS ALONG THE NORMAL HIGH WATER MARK OF THIS RIVER (LOW WATER MARK) DB 344, PG 141

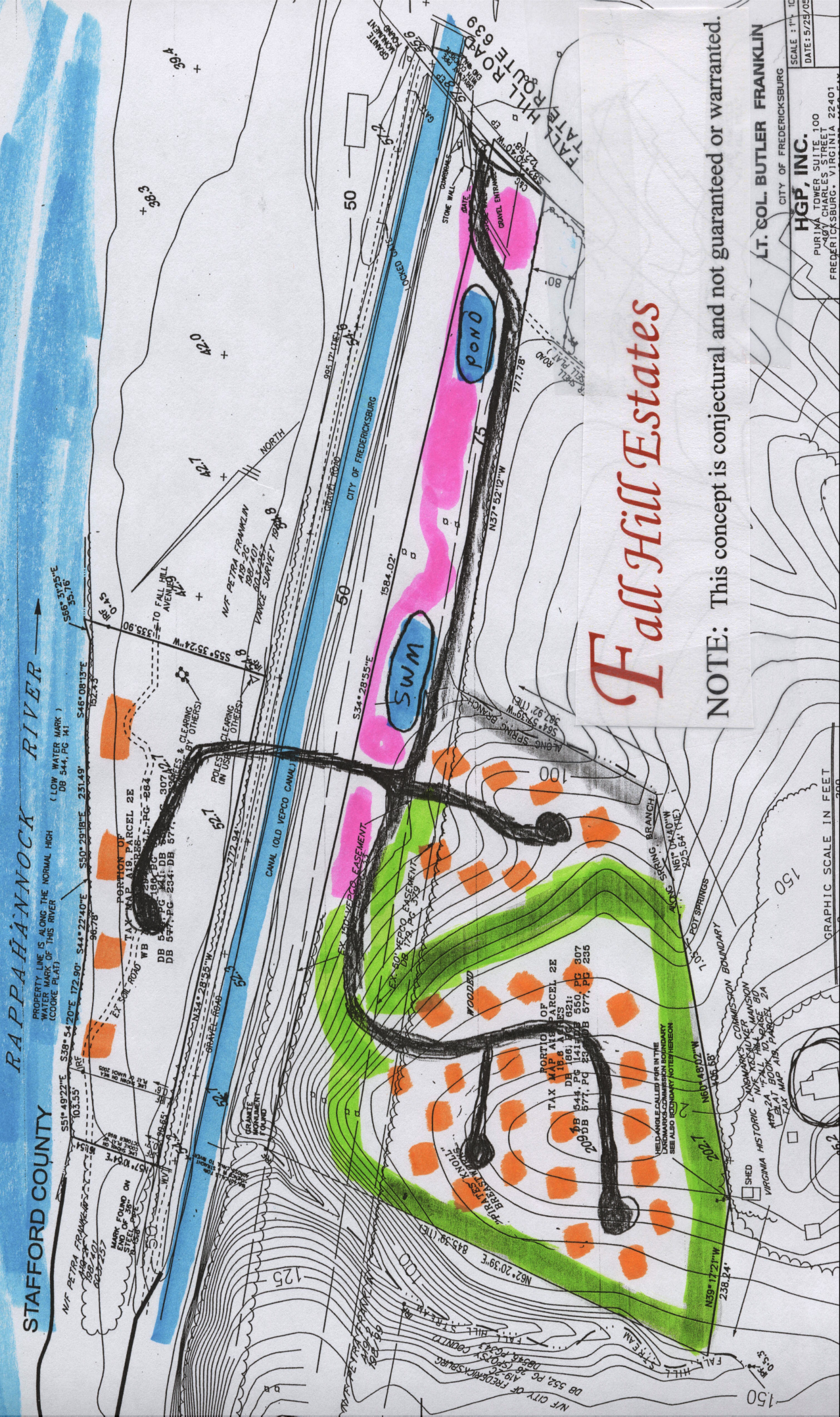

Fall Hill Estates

NOTE: This concept is conjectural and not guaranteed or warranted.

LT. COL. BUTLER FRANKLIN
 CITY OF FREDERICKSBURG
HGP, INC.
 PURIMA TOWER SUITE 100
 409 CHARLES STREET
 FREDERICKSBURG, VIRGINIA 22401

SCALE: 1" = 100'
 DATE: 5/23/05

GRAPHIC SCALE IN FEET

551°49'22"E
 103.55'

538°54'20"E
 172.90'

S44°22'40"E
 98.78'

S50°29'18"W
 231.49'

S46°08'13"W
 102.23'

S55°35'24"W
 135.90'

S34°28'55"E
 1584.02'

S37°52'12"W
 1777.78'

N62°20'39"E
 845.39 (TIE)

N62°20'39"E
 845.39 (TIE)

N59°17'21"W
 238.24'

N61°40'0"W
 255.64 (TIE)

N61°40'0"W
 255.64 (TIE)

N61°40'0"W
 255.64 (TIE)

N61°40'0"W
 255.64 (TIE)

N61°40'0"W
 255.64 (TIE)

N61°40'0"W
 255.64 (TIE)

N61°40'0"W
 255.64 (TIE)

N61°40'0"W
 255.64 (TIE)

N61°40'0"W
 255.64 (TIE)

N61°40'0"W
 255.64 (TIE)

N61°40'0"W
 255.64 (TIE)

551°49'22"E
 103.55'

538°54'20"E
 172.90'

S44°22'40"E
 98.78'

S50°29'18"W
 231.49'

S46°08'13"W
 102.23'

S55°35'24"W
 135.90'

S34°28'55"E
 1584.02'

S37°52'12"W
 1777.78'

N62°20'39"E
 845.39 (TIE)

N62°20'39"E
 845.39 (TIE)

N59°17'21"W
 238.24'

N61°40'0"W
 255.64 (TIE)

N61°40'0"W
 255.64 (TIE)

N61°40'0"W
 255.64 (TIE)

N61°40'0"W
 255.64 (TIE)

N61°40'0"W
 255.64 (TIE)

N61°40'0"W
 255.64 (TIE)

N61°40'0"W
 255.64 (TIE)

551°49'22"E
 103.55'

538°54'20"E
 172.90'

S44°22'40"E
 98.78'

S50°29'18"W
 231.49'

S46°08'13"W
 102.23'

S55°35'24"W
 135.90'

S34°28'55"E
 1584.02'

S37°52'12"W
 1777.78'

N62°20'39"E
 845.39 (TIE)

N62°20'39"E
 845.39 (TIE)

N59°17'21"W
 238.24'

N61°40'0"W
 255.64 (TIE)

N61°40'0"W
 255.64 (TIE)

N61°40'0"W
 255.64 (TIE)

N61°40'0"W
 255.64 (TIE)

N61°40'0"W
 255.64 (TIE)

N61°40'0"W
 255.64 (TIE)

N61°40'0"W
 255.64 (TIE)